

Cable inlet $\frac{1}{2}$ " Gas - double

Three $\varnothing 7$ equidistant fixing holes

horizontal on right side

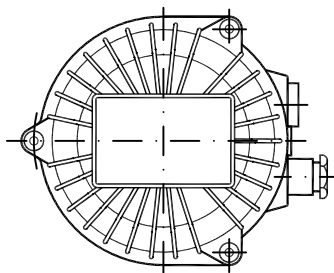

1	Stainless steel tube with flange
2	Spacers in lagging material
3	Coupling in lagging material

Suitable for environments and materials with a high percentage of moisture and in the presence of steam.
Enables condensate to be drained off.

IP65 Protection

WIRING

- 1 - Common power supply
- 2 - Power supply 110 Va.c. 50/60 Hz
- 3 - Power supply 220 Va.c. 50/60 Hz
- 6 - NC contact 10A/250 Va.c.
- 7 - Common contacts
- 8 - NO contact 10A/250 Va.c.

Ambient temperature range -20 to $+70$ °C

Weight : 3.650 Kg

On request power supply at 24/48 Va.c. 50/60 Hz or power supply at 24 Vd.c.

Electric motor draw 4 W

Maximum operational pressure 1.1 bar

Max. temperature inside storage bin 200 °C

Certificate number TÜV IT 16 ATEX 063 X
Marking: II 1/2 D Ex ta/tb IIC T85°C IP65 Da/Db

